



**WACKER  
NEUSON**  
*all it takes!*



## EW100

### Wheeled Excavator

#### Innovative thinking - the future of wheeled excavators

The EW100 sets new standards in terms of performance, safety and comfort, considerably ahead of just about every other wheeled excavator in a drag race. The collaboration of attachment management and assistance systems with an optimized field of vision around the machine could not be better adapted to everyday construction site work. Preparations for 2D & 3D control systems are already installed in such a way that they can easily be retrofitted without adaptations, depending on the operator's preference! And it is possible to operate every attachment without downturns with twice as much auxiliary hydraulics power.

### Highlights

- Very good all-round visibility
- Topmost performance in all areas
- Human Machine Interface HMI
- Trailer operation
- Copy of Kopie von Template Feature & Benefit

### Technical Data

#### Hydraulic

Operating pressure	300.0 bar
Flow rate	180.0 l/min

#### Mechanical - Output Details

Nominal Engine speed	1,900.0 1/min
Travel speed	30.0 km/h
Travel speed (Option)	40.0 km/h

#### Mechanical Details

Length	6,707.0 mm
Width	2,450.0 mm
Height	2,980.0 mm
Operating weight	10,320.0 kg
Operating weight (min.-max.)	10,625.0 - 11,855.0 kg
Digging depth (max.)	4,968.0 mm

#### Engine

Cooling	Water-cooling
Engine type	Turbodieselengine
Cylinder	4.0
Cylinder capacity	2,799.0 cm <sup>3</sup>
Tank capacity	190.0 l

Oil filling max.	9.8 l
Effective power	55.4 KW
Nominal Engine speed	1,900.0 1/min
Maximum torque	300.0 Nm
Air cleaner	Dry air filter
Starter battery Voltage	12.0 V
Manufacturer	Perkins
Engine designation	904J-E28T
Stroke	110.0 mm
Bore	80.0 mm

#### Environment Data

Exhaust-gas limit	EU Stage V
-------------------	------------

#### Operating Fluids

Oil volume	9.800 l
Cooling fluid volume	13.2 l

#### Chassis

Operating pressure	440.0 bar
Flow rate	180.0 l/min

#### Shipping and Storage

Shipping weight	10,320.0 kg
-----------------	-------------

The illustrations, equipment and data shown may deviate from the current delivery program of your country. Optional equipment subject to additional charge may be shown. Subject to changes.

## Dimensions

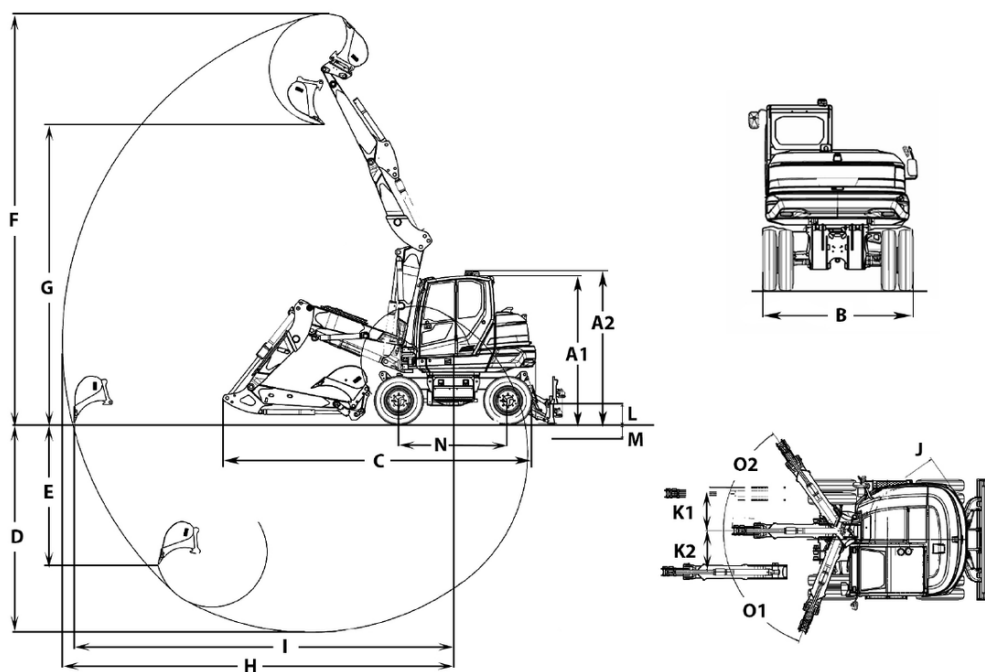

A1	Height with cab	2,963 mm
	Height of dozer blade	495 mm
A2	Total height with rotating beacon	3,057 mm
B	Width travel gear	2,450 mm
C	Transport length	6,314 mm
D	Digging depth max.	4,211.7 mm
E	Piercing depth max.	2,858.3 mm
F	Piercing height max.	8,262.4 mm
G	Dumping height max.	5,582.1 mm
I	Max. reach at ground level	7,660.4 mm
J	Tail swing radius	1,690 mm
K1	Boom offset max. (to center of bucket right side)	940 mm
K2	Boom offset max. (to center of bucket left side)	625 mm
L	Stacking height max. (dozer blade above surface)	390 mm
M	Digging depth max. (dozer blade below surface)	136 mm
N	Wheel base	2,200 mm
O1	Max. swivel angle (arm system to the left)	70 °
O2	Max. swivel angle (arm system to the right)	55 °